

# LoadMaxx Plus & QuickLoad Plus Installation Guide

Retrofit



**For Trailers with Air Ride  
Suspensions  
Single HCV, Dual HCV & Full Trailers**

**Air-Weigh Customer Support: 888-459-3247**

# Table of Contents

<b>Trailer Overview.....</b>	<b>1</b>
Installation Overview Retrofit.....	1
Tools Required .....	2
<b>Mounting the Scale.....</b>	<b>2</b>
Mounting Flush to the Trailer.....	3
Mounting with a Van or Frame Rail Bracket.....	4
<b>Connecting Power to the Scale.....</b>	<b>5</b>
<b>Alarm Installation.....</b>	<b>6</b>
<b>Installing the Air Line .....</b>	<b>6</b>
<b>Checking the Installation.....</b>	<b>7</b>
A/D Readings and Significance.....	7
<b>Limited Warranty.....</b>	<b>8</b>
<b>Procedure for Warranty Claims.....</b>	<b>9</b>

# Trailer Overview

The scale works using sensors that measure air pressure changes in the trailer's suspension; it then converts those numbers into weight. The weight is displayed on the trailer display and displays weight per axle group. Weights are accurate to within 300 pounds (140 kilograms) and are displayed in 20-pound or 20-kilogram increments.

The LoadMaxx Plus version enables drivers to view steer, drive, trailer, GVW, and net payload on any LoadMaxx equipped tractor.

## Air-Weigh App

Download the Air-Weigh app and view weight data on any smart device. Available for download in the Apple and Android app stores.



## Installation Overview - Retrofit

There are three major components of the trailer scale that you will install to upgrade to the new LoadMaxx Plus or QuickLoad Plus:

- Trailer scale display / mounting bracket
- Power interface cable
- Use existing air line

## Tools Required

You will need the following tools to install the trailer scale and airline:

- Standard wrench set or adjustable wrench
- Flush wire cutter
- Needle nose pliers
- Flat-blade screwdriver

## Mounting the Scale

There are three ways you can mount the trailer scale. **You will use the existing holes on the trailer rail for the new bracket and scale if you are using the Van or Frame Rail bracket for install.**

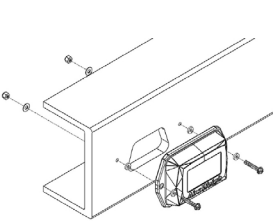

Flush Mount

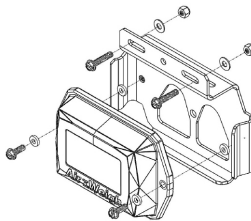

Van Bracket

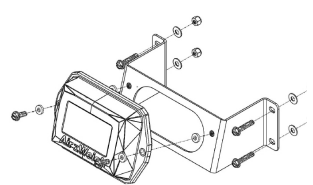

Frame Rail Bracket

## Mounting Flush to the Trailer

A flush mounted scale is mounted directly to the side of the trailer.

1. Remove the old scale, you will need to expand the port hole sizes for the new scale. Make sure the back side of the location is free of obstacles and debris that would interfere with the installation.
2. Use the supplied template (#904-0025) or hold the scale in the location you will mount it for reference and cut a hole large enough to fit the port connections on the back.

At this point, determine whether you want to connect the power to the display before or after you secure it to the trailer. If after, proceed to step 6 before completing steps 3-5. Reference chart on pg. 5 for connecting power to the scale.

3. Feed the power cables to the back of the trailer display from below the edge of the trailer or through the previously cut hole.
4. Remove the 1295 ComLink cable (only applies if you have a prior model that had a 1295 ComLink). This will be replaced with the new interface cable (#014-0350-101).
5. Plug the power interface cable into Port 1 on the back of scale display.
6. Place the scale over the space you have prepared on the trailer, making sure port holes fit the hole on the trailer. Use the provided bolts, rubber washers (one for each front and back of the scale) and nuts to secure the scale to the side of the trailer.
7. Apply the provided blue Loctite to all threaded bolts to prevent bolts from backing out.

**Note: The provided rubber washers are required to dampen the vibration.**

**Note: Do not overtighten mounting bolts. Torque to 10 inch lbs or 1.1 Nm.**

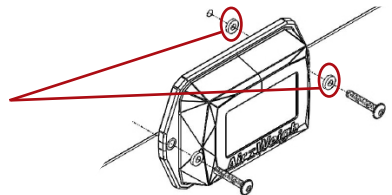

# Mounting with a Van or a Frame Rail Bracket

1. Remove the old scale and bracket.
2. Secure the scale to the bracket by using the provided bolts and rubber washers. Insert one bolt and washer on each side of the scale through each of the scale wing holes. Apply provided blue Loctite on threaded bolts.

At this point, determine whether you want to connect the power to the display before or after you secure the bracket to the trailer. If after, proceed to step 4 before completing step 3. Reference chart on pg. 5 for connecting power to the scale.

3. Remove the 1295 ComLink cable (only applies if you have a prior model that had a 1295 ComLink). This will be replaced with the new interface cable (#014-0350-101). Plug the power interface cable into Port 1 on the back of the scale.
4. Secure the bracket to the trailer surface using the existing holes from the previous bracket. Apply the provided blue Loctite to all threaded bolts before placing through the bracket and securing to the trailer, to prevent bolts from backing out.

**Do not overtighten mounting bolts. Torque to 6 inch lbs or .68 Nm.**

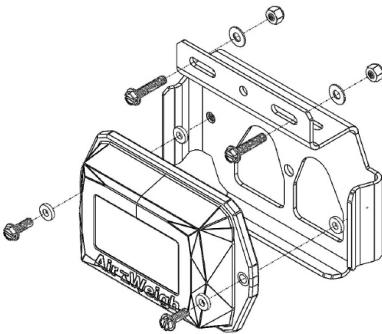

**Van Mounting Bracket**

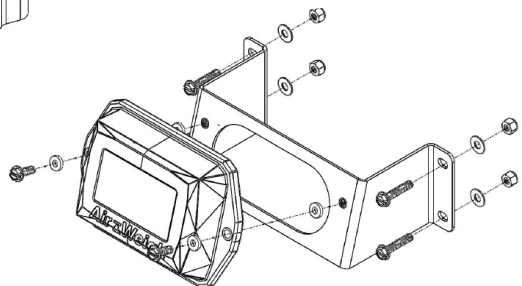

**Frame Rail Mounting Bracket**

# Connecting Power to the Scale

You will only replace the Interface cables - use existing Power Cable and ABS-T breakout from prior install.

## Power Cable Installation Guide

### 1. Scale Display

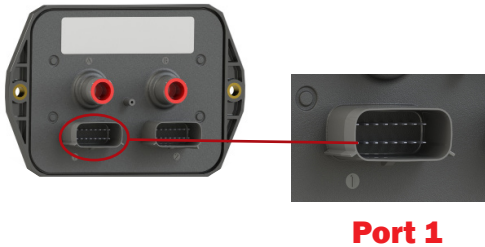

### 2. New - Interface Cable

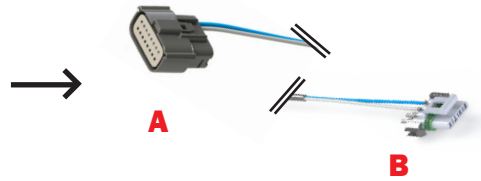

### 3. Power Cable (use existing)

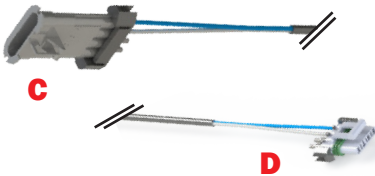

### 4. (use existing) ABS-T Breakout

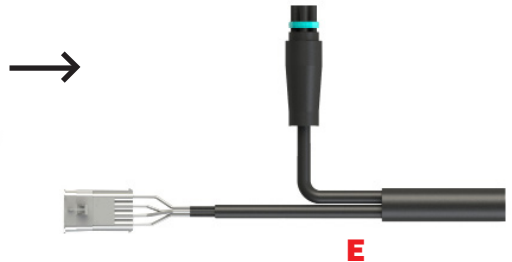

## Connection order

1. **Remove existing interface cable**
2. Plug New interface cable (A) into Scale Display Port 1
3. Plug interface cable (B) to Power Cable (C)
4. **Remove 1295 ComLink cable** (if found, not all prior models will have this)
5. Plug Power Cable (D) into ABS T-Breakout (E) or wire Blunt cut end to junction box or lighting harness.

# Alarm Installation

**Note:** If you ordered the Alarm Cable with your scale, follow the below instructions for install.

Insert the Alarm cable into Port 2 on the back of the scale. The gray, sealed wire from the main wiring harness is the alarm circuit output. It can be connected to any self-grounded alarm device with a current draw of 1.0 amps or less. The alarm output voltage will be the same as the vehicle voltage. You must install a relay for any device that draws more than 1.0 amps. Do not disturb the sealed end of the wire if alarm is not installed.

When using an alarm, connect the alarm output wire and the ground return wire to the desired device. Ensure that any unused alarm wires are electrically insulated.

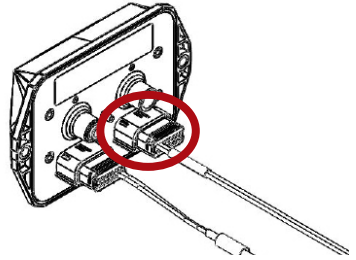

**IMPORTANT:** Leave the dummy plug in Port 2 installed if you are not installing an alarm cable.

# Installing the Air Line



1. Cut the existing airline from the old trailer scale.
2. Place this airline into Port A of the new trailer scale.

Note: If you are installing on a full or dual trailer, you will use Port A and Port B. The second air line will come from an airbag controlled by the second HCV.



# Checking the Installation

After you finish installing your scale, follow the steps below to make sure you have installed the scale correctly. This will prevent the user from running into issues when calibrating and using the scale.

1. With power to your trailer, turn on your scale. If the scale is off, touch the screen to wake it up
2. Select the image of a wrench  to go to the Setup menu
3. Select the medical bag  to go to Scale Diagnostics
4. Press the down arrow  until you see information on A/D readings. The screen should show a number. That number is your A/D reading. Use the table below to determine if your A/D reading is appropriate.

Note: For Full or Dual HCV trailers, you will see two sensor readings from Port A and Port B.

5. If the A/D readings are appropriate, your trailer has been installed correctly. If they are off, check all connections and make sure they are securely attached. Then check the height control valve to see if it is loose or broken, which can cause inaccurate A/D readings.

## A/D Readings and Significance

A/D Reading	Should Reflect
450 or less (may read N/A)	Air bag deflated, no weight - equivalent to 0 pounds
929 to 2518 approx.	Appropriate for an empty trailer
2700 to 4096 approx.	Appropriate for a trailer loaded to full capacity

Note: If you're getting 450 and your air bags are fully inflated, please contact our support team for assistance.

# Limited Warranty

Air-Weigh warrants (the "Limited Warranty") that the Products will be free from defects in material and workmanship under normal use and service with proper maintenance for the following time periods:

- (a) for new Scale kits, the Limited Warranty period will be 3 years;
- (b) for new parts and accessories sold separately, the Limited Warranty period will be 1 year; and
- (c) for repaired or refurbished items, including repaired or refurbished Scale kits and repaired or refurbished parts and accessories sold separately, the Limited Warranty period will be 90 days.

If any Product is determined to not conform to this Limited Warranty during its applicable Limited Warranty period, Air-Weigh will, at its exclusive option, either repair or replace the Product.

Limitations of Limited Warranty. Air-Weigh will have no obligation under the Limited Warranty with respect to any product if (a) Buyer fails to notify Air-Weigh in writing during the warranty period of a non-conformity, or (b) Buyer or any other person, entity, or governmental authority uses, misuses, or neglects the product in a manner inconsistent with the product's specifications or directions for use or maintenance, modifies the product or improperly installs, handles, or maintains the product.

**No Repair or Modification of the products.** Except as explicitly authorized or in a separate written agreement with Air-Weigh, Buyer will not service, repair, modify, alter, replace, reverse engineer, or otherwise change any of the products.

**Disclaimer of All Other Warranties.** EXCEPT FOR THE LIMITED WARRANTIES SET OUT ABOVE, NEITHER AIR-WEIGH NOR ANY PERSON OR ENTITY ON AIR-WEIGH'S BEHALF HAS MADE OR MAKES FOR BUYER'S BENEFIT ANY EXPRESS OR IMPLIED REPRESENTATION OR WARRANTY WHATSOEVER, INCLUDING ANY WARRANTIES OF: (i) MERCHANTABILITY; (ii) FITNESS FOR A PARTICULAR PURPOSE; (iii) TITLE; OR (iv) NON-INFRINGEMENT; WHETHER ARISING BY LAW, COURSE OF DEALING, COURSE OF PERFORMANCE, USAGE OF TRADE OR OTHERWISE, ALL OF WHICH ARE EXPRESSLY DISCLAIMED. BUYER ACKNOWLEDGES THAT IT HAS NOT RELIED ON ANY OTHER REPRESENTATION OR WARRANTY MADE BY AIR-WEIGH, OR ANY OTHER PERSON OR ENTITY ON AIR-WEIGH'S BEHALF.

## **Limitation of Liability.**

IN NO EVENT WILL AIR-WEIGH BE LIABLE FOR CONSEQUENTIAL, INDIRECT, INCIDENTAL, SPECIAL, EXEMPLARY, PUNITIVE, OR ENHANCED DAMAGES, LOST PROFITS OR REVENUES, OR DIMINUTION IN VALUE, ARISING OUT OF OR RELATING TO ANY BREACH OF THESE TERMS, REGARDLESS OF WHETHER OR NOT THE DAMAGES WERE FORESEEABLE, WHETHER OR NOT AIR-WEIGH WAS ADVISED OF THE POSSIBILITY OF THE DAMAGES, OR THE LEGAL OR EQUITABLE THEORY (CONTRACT, TORT, OR OTHERWISE) ON WHICH THE CLAIM IS BASED.

IN NO CASE WILL AIR-WEIGH'S AGGREGATE LIABILITY ARISING OUT OF OR RELATED TO THESE TERMS, WHETHER ARISING OUT OF OR RELATED TO BREACH OF CONTRACT, TORT (INCLUDING NEGLIGENCE), OR OTHERWISE, EXCEED THE TOTAL OF THE AMOUNTS PAID TO AIR-WEIGH FOR THE PRODUCTS.

THE FOREGOING LIMITATIONS APPLY EVEN IF BUYER'S REMEDIES UNDER THESE TERMS FAIL OF THEIR ESSENTIAL PURPOSE.

# Procedure For Warranty Claims

ALL customers should first contact Air-Weigh Customer Support Department at (888) 459-3247 for questions regarding the use, operation, repair or return of any Air-Weigh product.

In the event Air-Weigh requests to examine the product prior to disposition OR for repair or replacement, Air-Weigh requires a Return Material Authorization (RMA) number be issued before the item is returned. Customer Support will issue the RMA number. Please reference this RMA number in all correspondence.

Claimed items shall be shipped freight pre-paid to:

Air-Weigh  
Customer Support Department  
1720 Willow Creek Circle, Suite 510  
Eugene, Oregon 97402, USA

The Air-Weigh RMA number **must** appear on the outside of the return packaging. Air-Weigh shall examine returned material within 30 days after receipt, or sooner if mutually agreed upon. If Air-Weigh determines that the part or assembly was defective in material or workmanship and within the warranty period, Air-Weigh will repair or replace the part or assembly and return freight pre-paid. In the event Air-Weigh determines that the part or assembly cannot be repaired or replaced and is within the warranty period, a credit not to exceed the purchase price will be issued to the Air-Weigh customer.

For our customers using purchase orders Air-Weigh will process a credit memo and notify the customer by email or fax. The customer will process a corresponding debit memo and notify Air-Weigh accordingly.

If the part or assembly received by Air-Weigh does not meet the requirements of the warranty program set forth above, at the Air-Weigh customer's request the part or assembly will either be discarded, returned freight collect, or repaired or replaced at the Air-Weigh customer's expense and returned freight collect.

## **Air Weigh**

1730 Willow Creek Circle • Eugene, OR 97402-9152 USA  
P.O. Box 24308 • Eugene, OR 97402-0437 USA

Telephone (541) 343-7884 • Order Desk (888) 459-3444  
Customer Support (888) 459-3247 • Fax (541) 431-3121

[www.Air-Weigh.com](http://www.Air-Weigh.com)